

Features & Applications

MR Basic™ is an economical LED based MR-16 lamp that can retrofit into standard MR-16 fixtures, sockets and transformers. Fitted with a 3W Cree High Power LED and a new heat finned lamp head, MR Basic provides respectable intensity at an affordable price. It has an improved driving circuitry that allows the use of electronic transformer, magnetic coil transformer and DC power supply. It is suitable for interior, retail and exhibit applications, especially where heat and maintenance have to be kept to the minimum. .

Dimensions

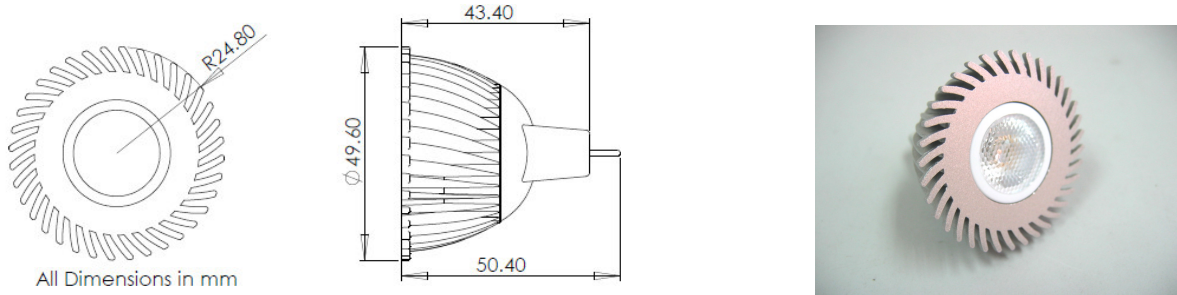

Product Specification

Light Source	1x 3W Cree High Power LED
Power Input	3.6W, 12VAC/DC
Luminous Flux	145 lm (Day Light)
Lens Options	Standard: 30 deg
Colour Options	Day Light (Typ 6000K), Warm White (Typ 3000K)
Transformer Options	Magnetic or Electronic
Base	GU5.3
Operating Temperature	-10~ 40 deg C
Estimated Lamp Life	50,000 Hours

Models

PMX-830YY

YY	Digits depict lens angle	30 Deg
X	Alphabet depicts LED colour	B: Day Light, E: Warm White

Prime Light Pte Ltd reserves the right to change the specification without prior notification.